

SPMCL 200 → LOCKING PROCEDURE

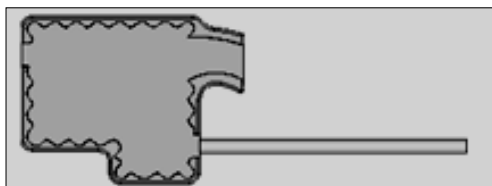

Diagram A

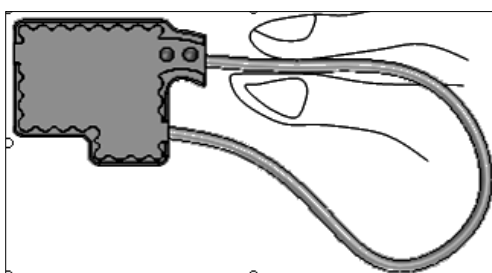

Diagram B

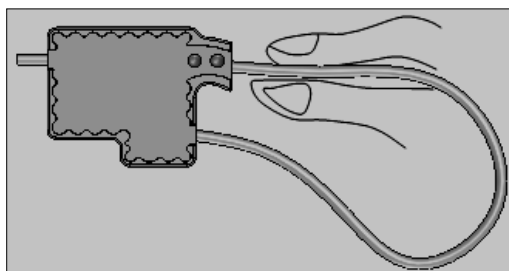

Diagram C

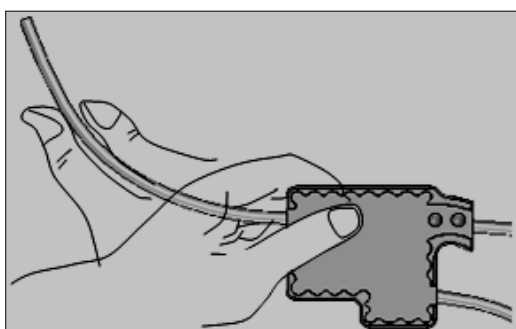

Diagram D

STEP 1

Make sure the seal body being placed with the front side facing the user, as shown in Diagram A.

STEP 2

Hold the seal body using one hand and with the other, insert the wire to the entry hole, as shown in Diagram B.

STEP 3

Then, push the wire through till it appears at the exit hole, on the other side, as shown in Diagram C.

STEP 4

Finally, pull the wire tight till the maximum and ensure there is no gap left after sealing, as shown in Diagram D.